



6203 NR Deep groove ball bearings

- SKF Explorer

Deep groove ball bearings

Bearing data

[Tolerances](#),

Normal (metric), P6, P5, Normal (inch),

[Radial internal clearance](#),

Matched bearing pairs, Stainless steel
d < 10 mm, Other bearings

Bearing interfaces

[Seat tolerances for standard conditions](#),

[Tolerances and resultant fits](#)

Technical specification

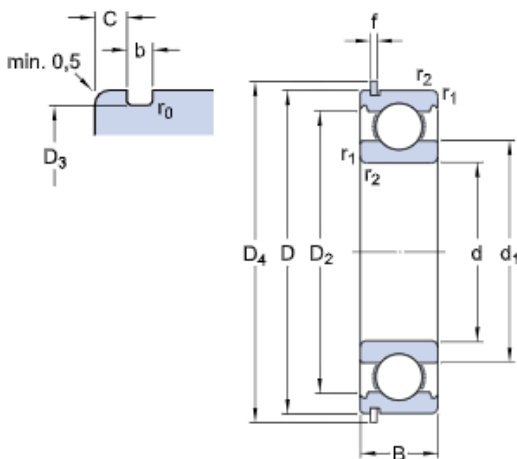

DIMENSIONS

d	17 mm	Bore diameter
D	40 mm	Outside diameter
B	12 mm	Width
d_1	≈ 24.5 mm	Shoulder diameter
D_2	≈ 34.98 mm	Recess diameter
D_3	38.1 mm	Diameter of snap ring groove
D_4	44.6 mm	Outside diameter of snap ring
b	1.35 mm	Width of snap ring groove
C	2.06 mm	Distance outer ring from side face to snap ring groove
f	1.12 mm	Width of snap ring
r_0	max. 0.4 mm	Bottom radius of snap ring groove
$r_{1,2}$	min. 0.6 mm	Chamfer dimension

ABUTMENT DIMENSIONS

d_a	min. 21.2 mm	Diameter of shaft abutment
D_a	max. 35.8 mm	Diameter of housing abutment
D_b	min. 46 mm	Diameter of snap ring recess in the housing

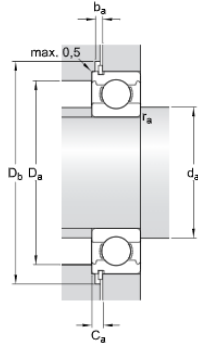

b_a	min. 1.5 mm	Width of snap ring recess in the housing
C_a	max. 3.18 mm	Distance from outer ring side face to snap ring back face
r_a	max. 0.6 mm	Radius of shaft or housing fillet

CALCULATION DATA

C	9.95 kN	Basic dynamic load rating
C_0	4.75 kN	Basic static load rating
P_u	0.2 kN	Fatigue load limit
	38 000 r/min	Reference speed
	24 000 r/min	Limiting speed
k_r	0.025	Minimum load factor
f_0	13	Calculation factor

MASS

	0.065 kg	Mass bearing
--	----------	--------------

INCLUDED PRODUCTS

SP 40	Snap ring
-------	-----------

TOLERANCE CLASS

P6	Dimensional tolerances
P5	Radial run-out